

Interpretation Services Available

- Spanish

¿Necesita un intérprete de árabe o español?

Haga clic en el botón «Interpretation» cerca de la parte inferior de la pantalla y elija el idioma que prefiere.

Se le ingresará a una sala de reuniones para ese idioma.



Team Introduction



- Fairfax County Public Schools
 - Jessica Gillis – Special Projects Administrator
 - Holli McKinley – Acting Coordinator III / Architectural Engineer II
 - Andrew Peterson – Civil Engineer II



- Consultant Team
 - Hughes Group Architects – Architect of Record
 - LandDesign – Civil Engineer
 - Ehlert Bryan – Structural Engineer
 - Strickler Associates – MEP Engineer
 - Hunton Andrews Kurth – Land Use Counsel

Project Need & Funding

- FCPS Strategic Goals
 - Student Success
 - Resource Stewardship
- School is over capacity, classroom space is needed
 - 1,991 Current student capacity
 - 2,500 Projected student capacity
- Planning and Design funded by 2017 School Bond
- Construction funded by 2019 School Bond

Community Outreach to Date

- December 9, 2019
 - Parent, Teacher, Student Association (PTSA) Presentation
- October 27, 2020
 - Mason District Land Use Committee Presentation
- December 8, 2020
 - Community Presentation
- January 20, 2021
 - Minor site plan notices for School Additions sent to community
- February 16, 2021
 - Minor site plan notices for School Additions sent to community
- March 01, 2021
 - School design committee meeting
- March 10, 2021
 - PTSA presentation
- March 11, 2021
 - Dr. Ricardy Anderson, Chair – School Board Mason District, Listening Session
- May 6, 2021
 - Community Meeting
- September 2021
 - Notices sent to Community for October 12, 2021 meeting

Project Scope

- Cafeteria expansion
- 3-story Addition to an existing school
 - The spaces of the Addition include core classrooms, science labs, modeling and tech lab spaces, and special education spaces
- Proposed Parking at Justice High School

Project Timeline

SCHOOL IMPROVEMENTS

PERMITTING

Building Plan Submitted (8/2020) – Complete
Site Plan Submitted (11/2020) – Under Review
Final Site Plan by 9/2022

BID OPENING

FALL 2022

CONSTRUCTION START

WINTER 2022/2023

PROJECT COMPLETION

FALL 2024

Key Project Drivers and Considerations

- Student, staff, and community safety
- Constricted site with limited areas for expansion
- Cost and Budget
- Parking alternatives:
 - Onsite Surface Parking
 - Maximum parking achieved
 - Peace Valley Lane
 - Parallel parking achieved
 - Perpendicular/Angled head-in parking infeasible due to traffic, speed, and sight lines
 - Structured Parking Garage
 - Safety concerns
 - Cost prohibitive
 - Site impacts
- May 06, 2021 Community Discussion

Existing Conditions

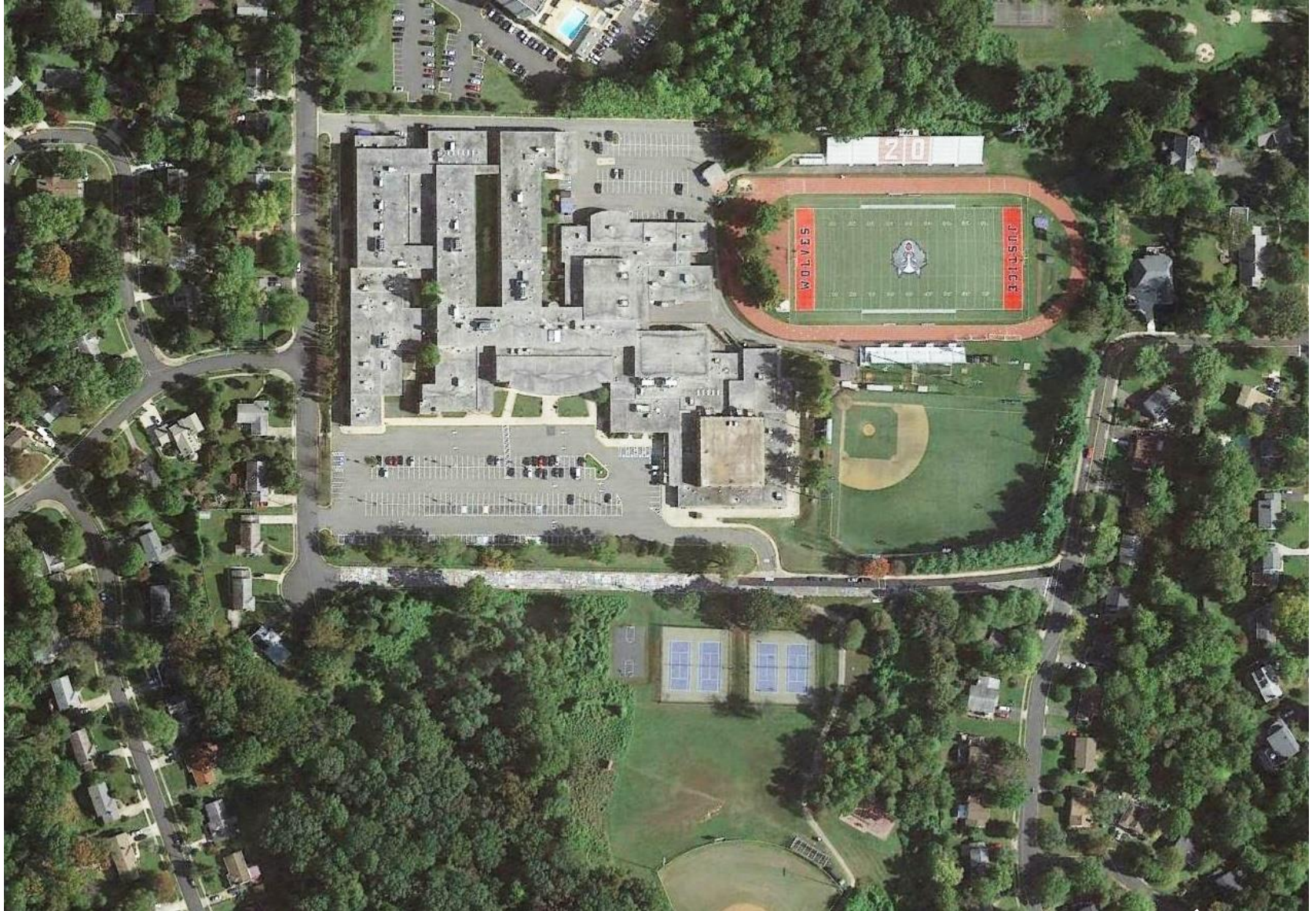

Preliminary Concept Site Plan – Presented to Community 12/08/2020

JUSTICE HIGH SCHOOL & PARK CONCEPT SITE EXHIBIT

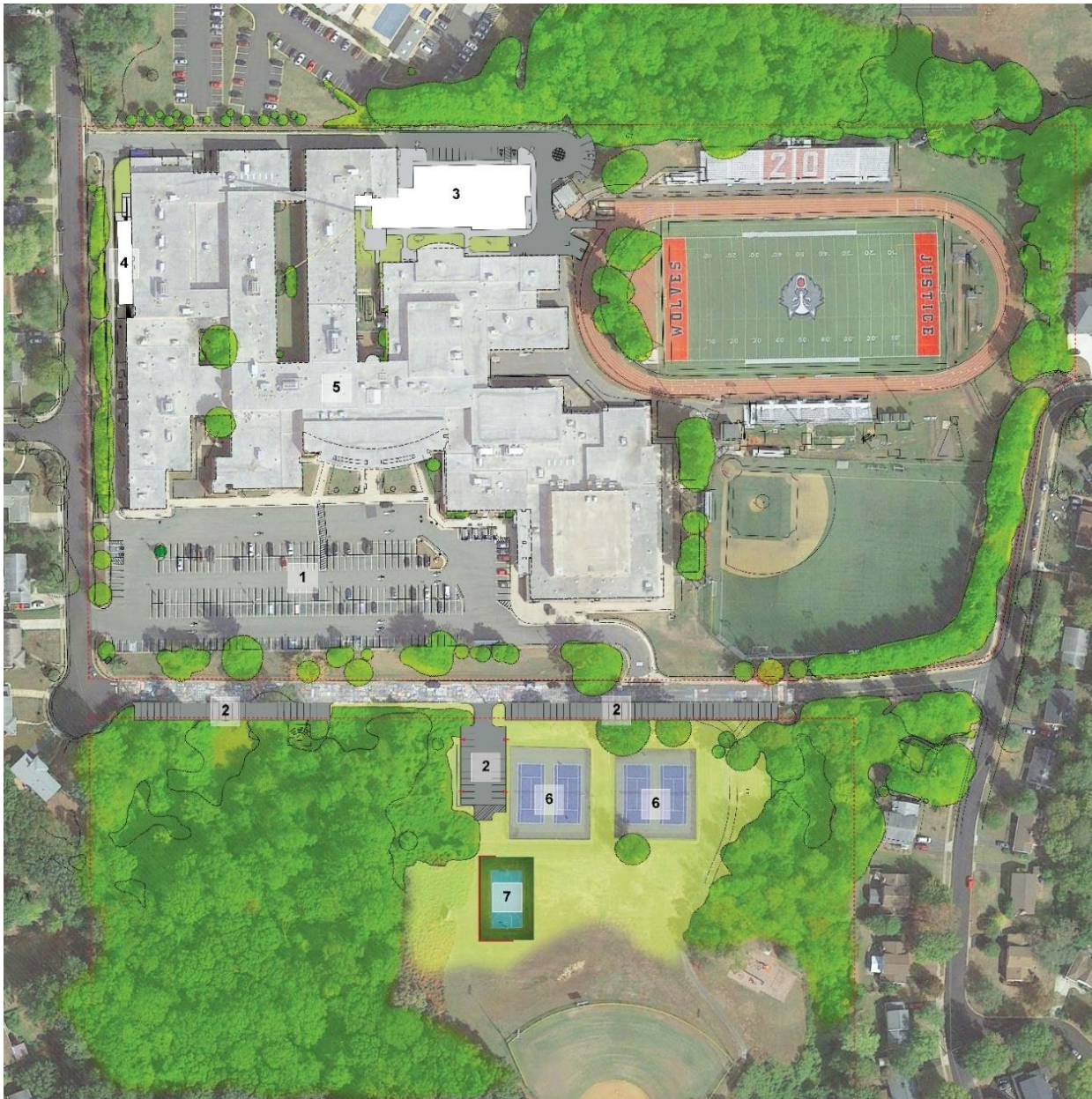

- 1 EXISTING PARKING
- 2 NEW PARKING
- 3 3-STORY CLASSROOM ADDITION
- 4 1-STORY CAFETERIA EXPANSION
- 5 EXISTING BUILDING
- 6 EXISTING TENNIS COURTS
- 7 RELOCATED BASKETBALL COURT

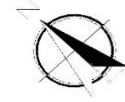

25 0 50 100
1" = 50'

Key Issues:

- Unsafe sight lines for head-in or angled parking along Peace Valley at East
- Substantial retaining walls for head-in parking or angled parking along Peace Valley at West
- New sidewalk feasibility along South side of Peace Valley
- Structured parking:
 - Available space
 - Budget
 - Maintaining school bus and emergency vehicle travel on school site
- Visibility impacts
- Relocated Basketball Court

Concept Site Plan – Presented to Community 05/06/2021

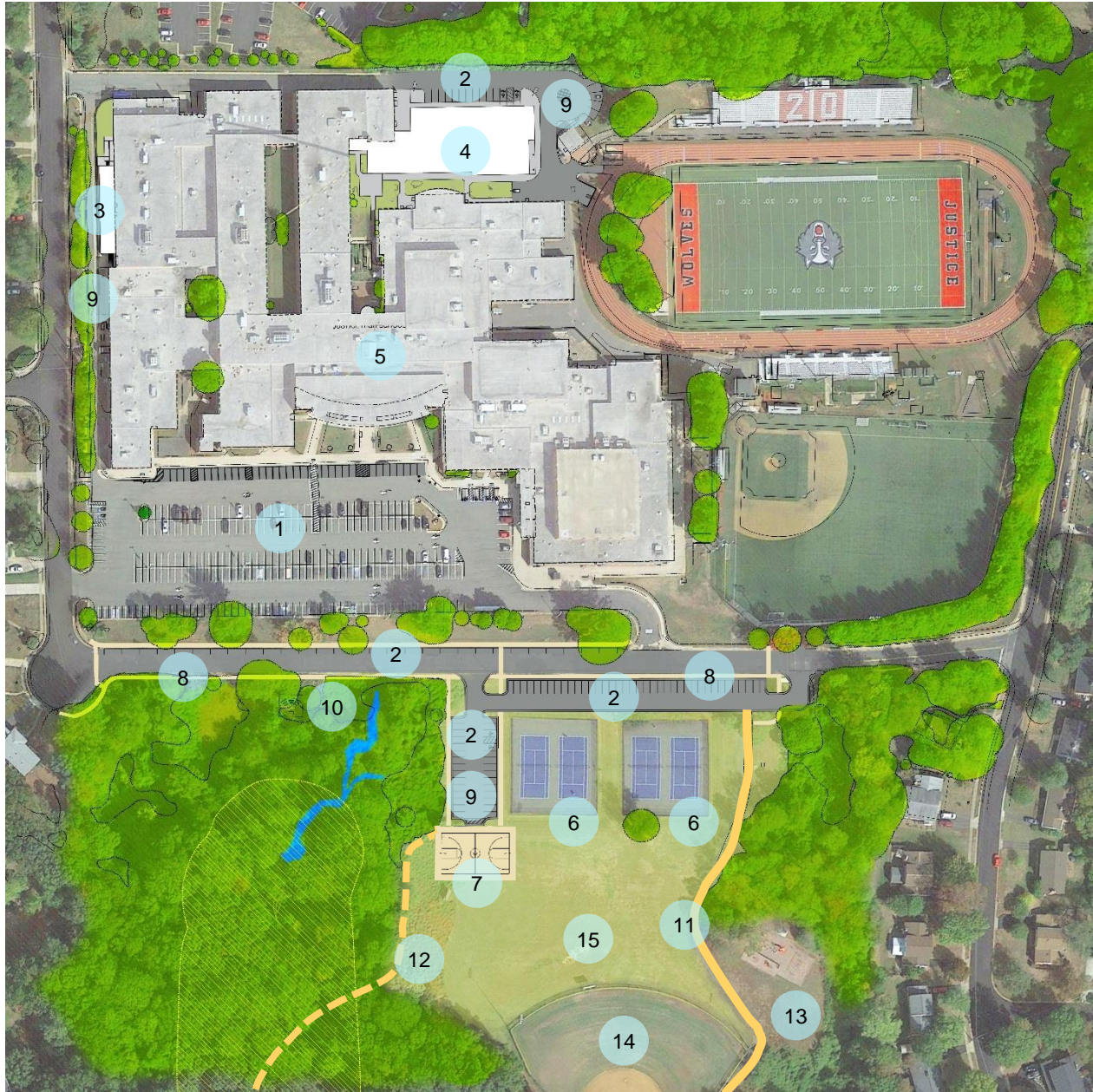

1. EXISTING PARKING
2. PROPOSED PARKING
3. 1-STORY CAFETERIA EXPANSION (1,818 GSF)
4. 3-STORY CLASSROOM ADDITION (43,431 GSF)
5. EXISTING BUILDING (293,401 GSF)
6. EXISTING TENNIS COURTS (109'x 122' ea.)
7. PROPOSED RELOCATION OF EXISTING BASKETBALL COURT (NEW, 50'x84')
8. NEW SIDEWALK
9. UNDERGROUND STORMWATER FACILITY
10. NEW PARK PAVILION
11. EXISTING TRAIL
12. NEW TRAIL - TBD
13. EXISTING TOT LOT
14. EXISTING SOFTBALL FIELD
15. OPEN FIELD SPACE

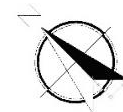

25 0 50 100
1" = 50'

Proposed Site Plan

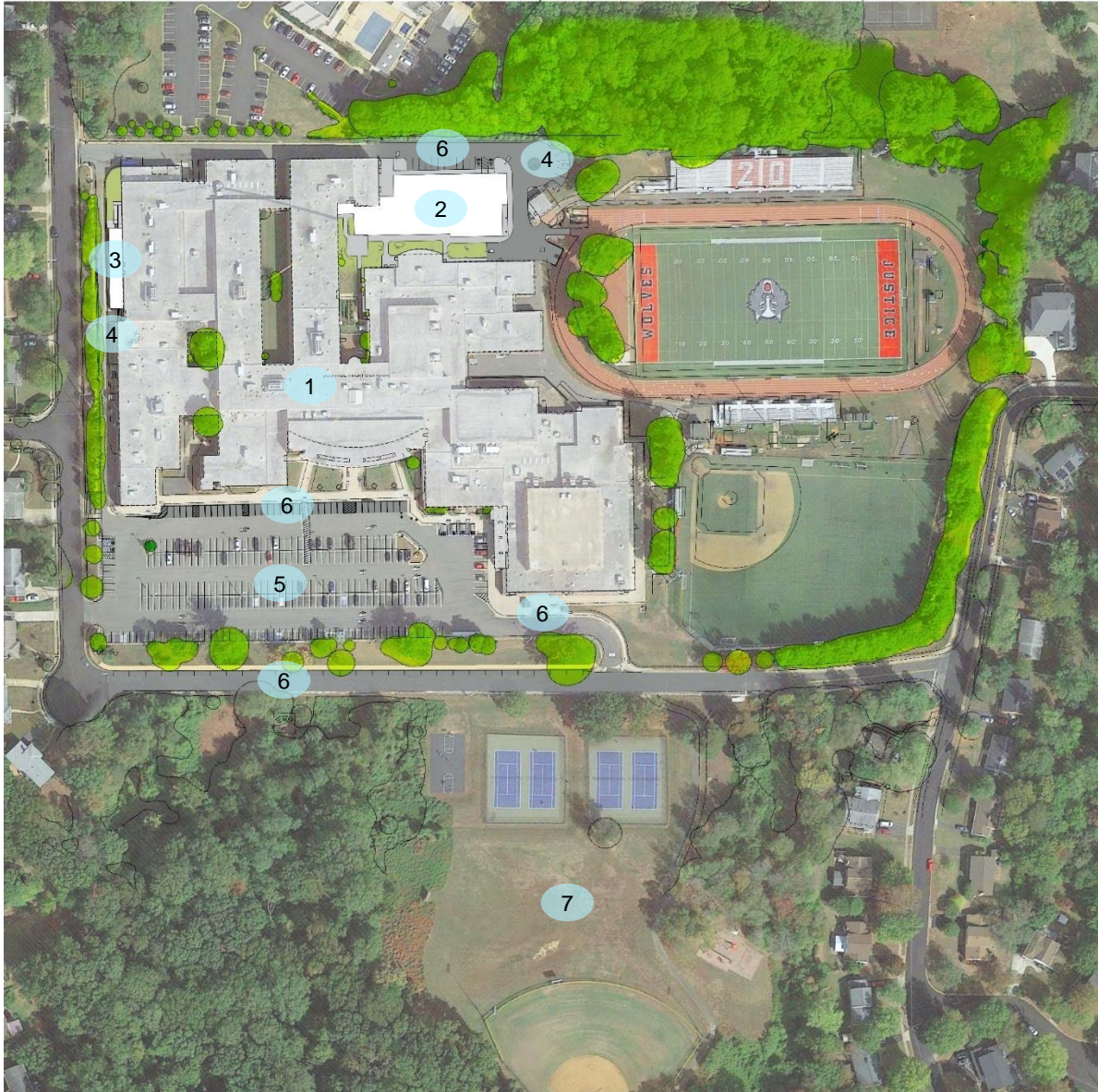

1. EXISTING BUILDING (293,401 GSF)
2. 3-STORY CLASSROOM ADDITION (43,431 GSF)
3. 1-STORY CAFETERIA EXPANSION (1,818 GSF)
4. UNDERGROUND STORMWATER FACILITY
5. EXISTING PARKING
6. PROPOSED PARKING
 - a. Classroom Addition Parking
 - b. Restriping of main parking lot
 - c. Parallel parking on Peace Valley Lane
 - d. Additional parking near entrance to lot
7. EXISTING JUSTICE PARK TO REMAIN

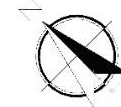

Parking Layout

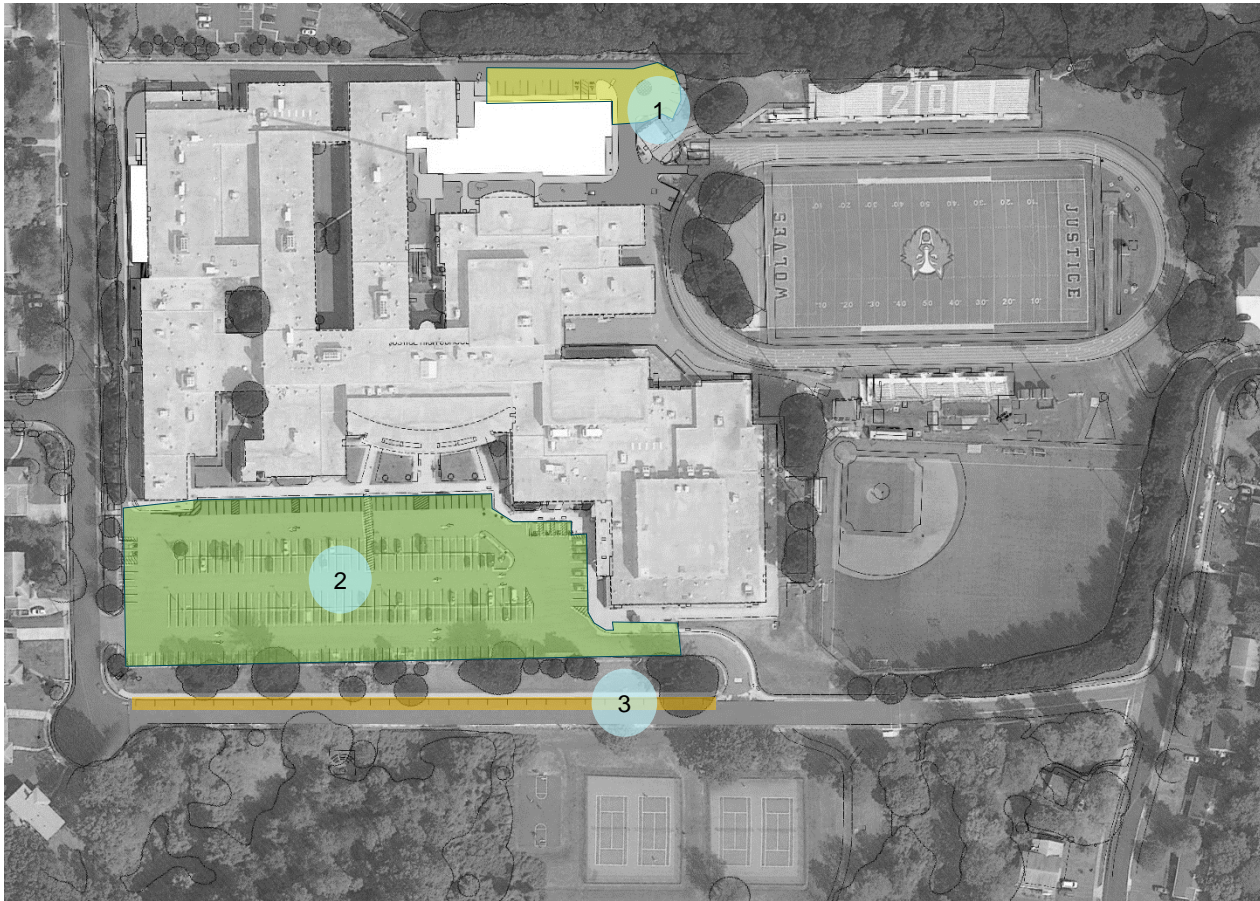

PARKING ANALYSIS

TOTAL EXISTING PARKING SPACES: **329**

CLASSROOM ADDITION PARKING: 81

SCHOOL'S MAIN PARKING: 248

PARKING ALONG PEACE VALLEY: 0*

PROPOSED PARKING:

TOTAL PROPOSED PARKING SPACES: **349**

CLASSROOM ADDITION PARKING: 18

SCHOOL'S MAIN PARKING: 302

PARKING ALONG PEACE VALLEY: 29

APPROXIMATE NET GAIN: 20 SPACES

Public Transportation

26A/28A – Metro Bus Routes at Route 7
(Rte. 7 and Row Street or Rio Street).

½ mile walk.

JHS BUS PASS/FFX CONNECTOR/PLANNED

	Parking Location	Existing	Proposed	Net Difference
1	Classroom Addition Parking	81	18	(63)
2	School's Main Parking	248	302	54
3	Parking Along Peace Valley	0*	29	29
	Totals	329	349	20

*Currently not striped

Cafeteria Addition

EXISTING CAFETERIA	7,703 GSF
CAFETERIA EXPANSION	1,818 GSF
TOTAL CAFETERIA	9,521 GSF



Cafeteria Addition - Elevation



West Elevation

Classroom Addition - First Floor Plan



Department Legend

- BUILDING SUPPORT
- MATH
- BUSINESS
- PE
- CIRCULATION
- SPEC ED
- ENGLISH
- TECH & ENGINEERING
- ESOL



Classroom Addition - Second Floor Plan



Department Legend

- BUILDING SUPPORT
- CIRCULATION
- ENGLISH
- SCIENCE
- SOCIAL STUDIES
- SPEC ED
- WORLD LANGUAGE



Classroom Addition - Third Floor Plan



Department Legend

- BUILDING SUPPORT
- MATH
- SCIENCE
- WORLD LANGUAGE



Classroom Addition - Elevations

Materials

- Brick
- Metal Panels
- Glass



East Elevation



North Elevation

Classroom Addition - Rendering



NEXT STEPS

1. FCPS files rezoning application to permit an increase in permitted gross floor area for the Additions.
2. FCPS files request for parking modification to reduce the number of parking spaces required by the Zoning Ordinance.



For updates please see go to:

<https://www.fcps.edu>

and search “Justice Addition” for information from this evening

Please note, the recording of this webinar, the presentation and a transcription of the Q&A session will be posted to the webpage by Friday, October 15th

Thank you!