

Differences Between Parent and Student Accounts

This handout accompanies the Schoology *Differences Between Parent and Student Accounts* video: <https://www.fcps.edu/node/41908>

- Parents have read only ability to students' activities.
- Parents are not able to participate as students.
- Students must be logged into their own account to participate in a course or group in Schoology.

Parent Accounts	Student Accounts
Cannot submit assignments (can view submissions)	Can submit assignments
Cannot post in discussions (sometimes may be able to view, depending on settings.)	Can post in discussions
Cannot access assessments	Can submit assessments
Cannot post in media albums (can view)	Can post to media albums
Unable to submit quizzes or tests on student behalf	Can attempt submissions of quizzes and tests

To view student or parent accounts, click the arrow in the upper right corner near your name and select the account you wish to view.

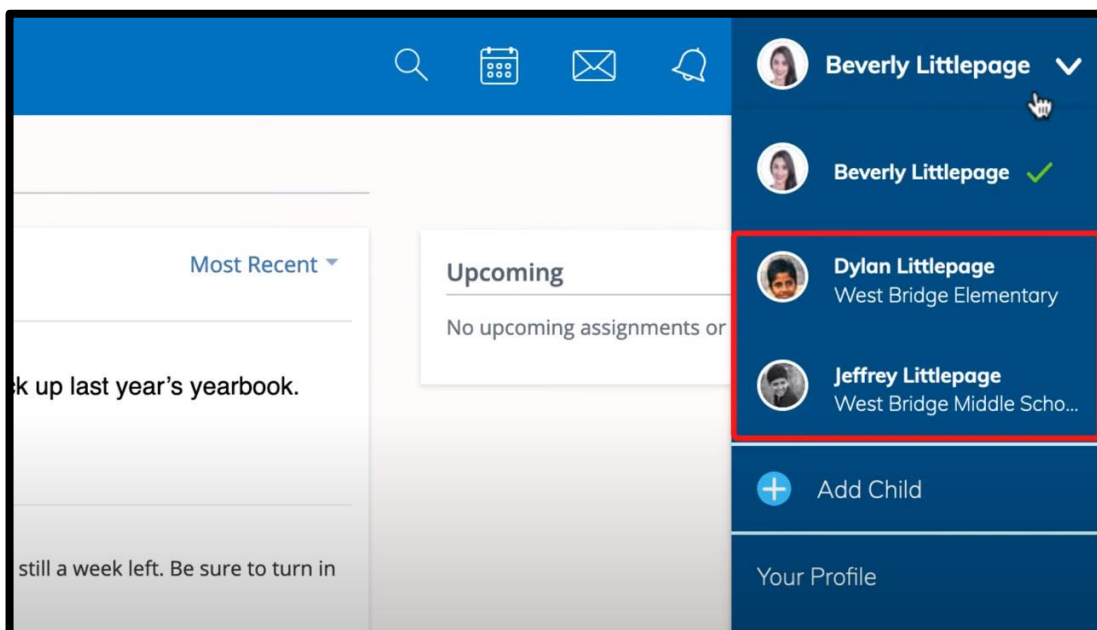

For more detailed information, see Schoology Support (<https://www.fcps.edu/schoology/support>).