

WILLOW SPRINGS ELEMENTARY SCHOOL

DESIGN COMMITTEE MEETING



Fairfax County
PUBLIC SCHOOLS
ENGAGE • INSPIRE • THRIVE

JUNE 6, 2022



SAMAHA

Team Introduction

- FCPS Design and Construction
 - Bradley James – Coordinator
 - Subhash Gambhir – Architectural Engineer

- Consultant Design Team
 - Samaha Associates – Architect
 - Pennoni – Civil Engineer
 - Ehlert Bryan – Structural Engineer
 - Strickler Associates – MEP Engineer

Design Committee Role

- Presentation and Review of Preliminary Design Options
 - Existing Condition
 - Areas of Addition
 - Areas of Renovation
 - Parking Configurations
 - Site Access and Traffic Flow
- Questions
- Suggestions
- Concerns
- Liaison with the Community

Project Timeline





- ❖ Schematic Design Phase 3/2022 - 5/2022
- ❖ Design Development Phase 5/2022 - 7/2022
 - Design Committee Meeting #1 6/6/2021
- ❖ Intermediate Design Phase 8/2022 - 11/2022
- ❖ Final Design Phase 11/2022 - 2/2023
- ❖ Permit Phase 3/2023 - 12/2023
- ❖ Construction Start Spring 2024
- ❖ Final Completion Fall 2026

Project Scope

- FCPS Educational Specifications – Modified Criteria
- Additions
 - New Classrooms
 - Improved Interior Building Circulation
 - Gym Expansion
- Renovations
 - Administrative Suite w/ Security Vestibule
 - Additional Staff Restroom Facilities
 - Reconfigured and Renewed Classrooms
 - Reconfigured and Renewed Support Spaces
 - New Mechanical and Plumbing Systems
 - Reconfigured Kiss & Ride Loop
 - Reconfigured Outdoor Play Areas
- Occupied Phased Construction

Existing Building – Site Plan



-  EXISTING SCHOOL
-  TO BE DEMOLISHED
-  NEW ADDITION
-  KISS AND RIDE DISEMBARKING AREA

WILLOW SPRINGS ES - EXISTING SITE



Existing Building – 1st Level

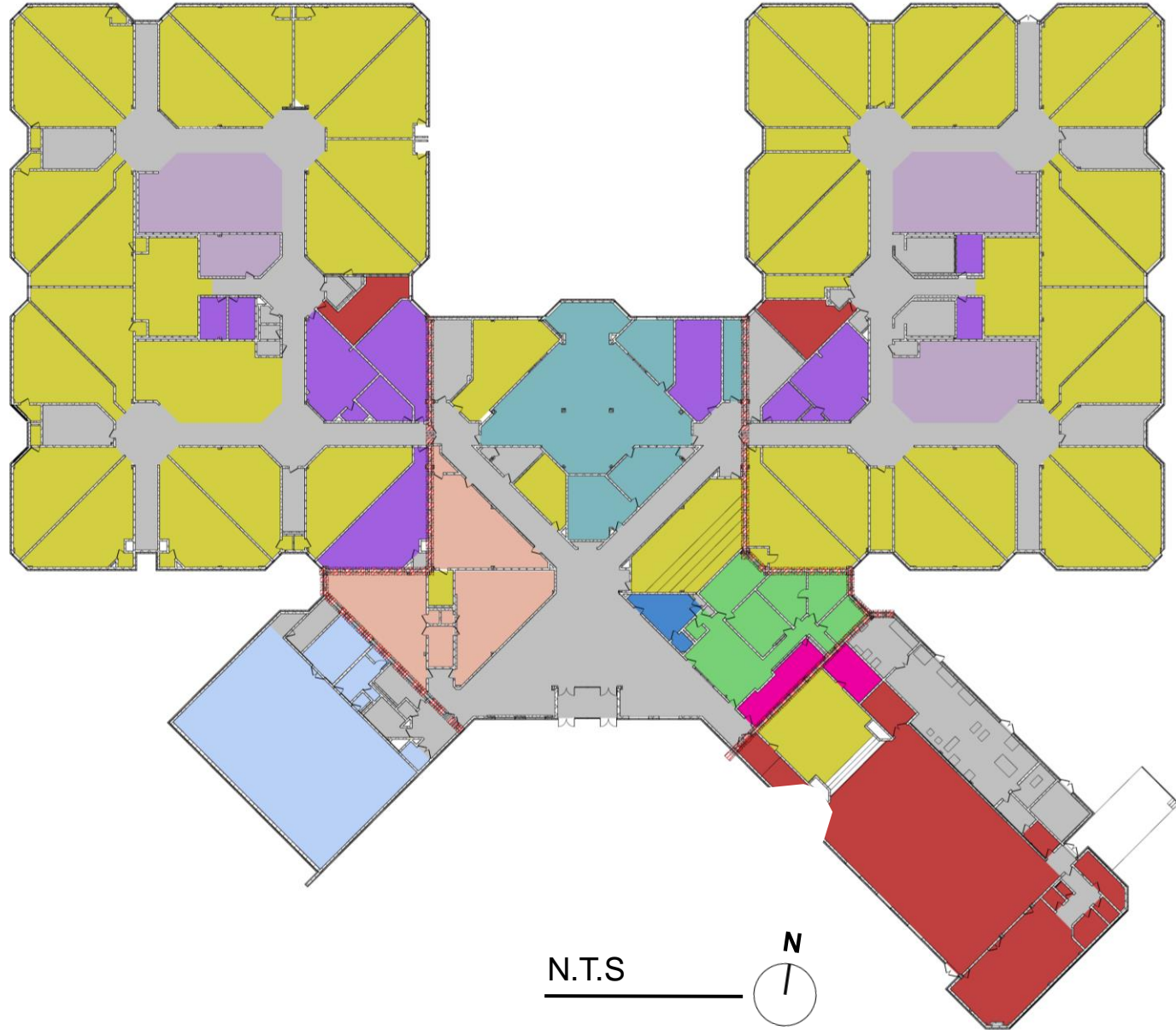

Design Option 1 – Site Plan

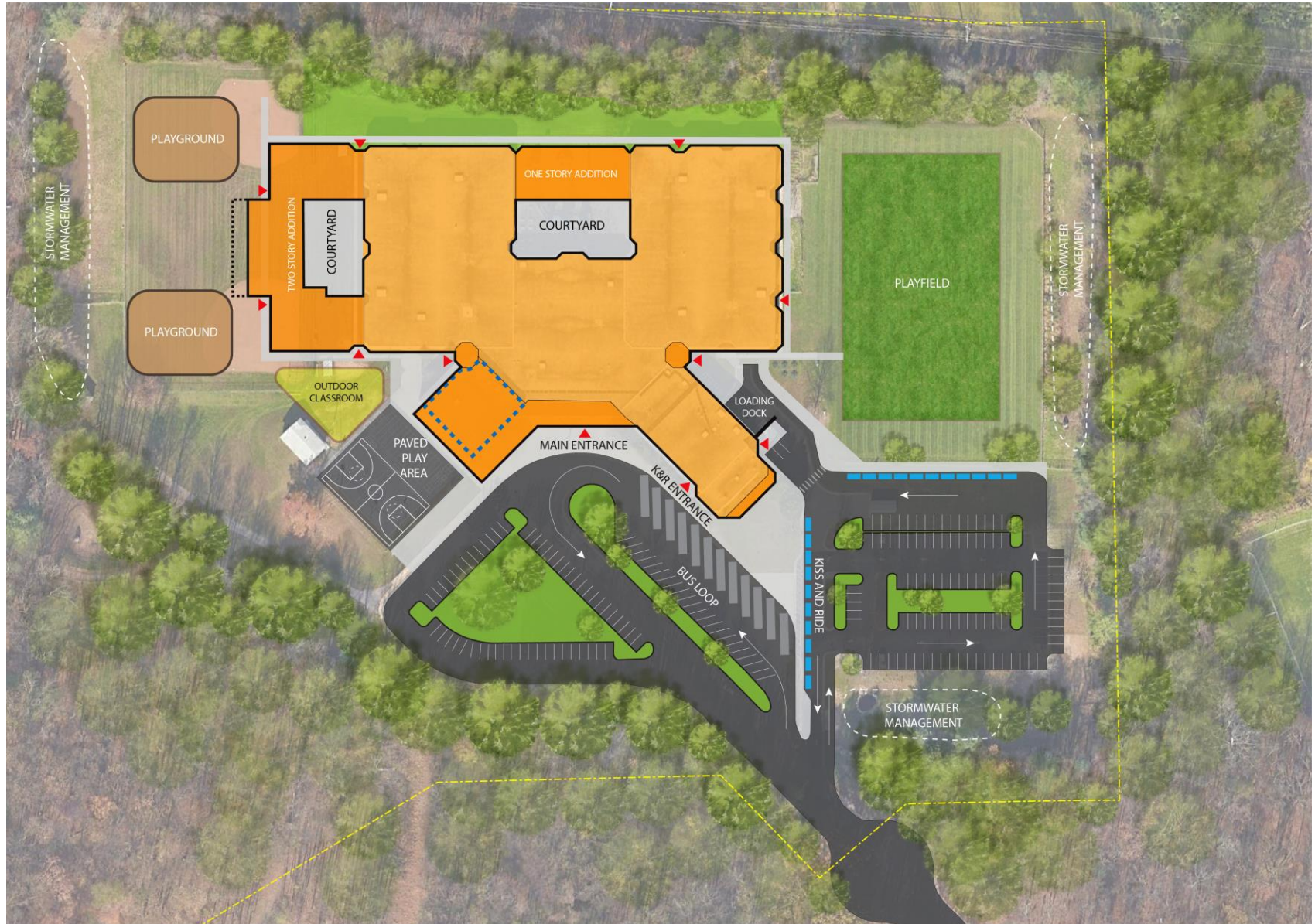

- EXISTING SCHOOL
- NEW ADDITION
- TO BE DEMOLISHED
- KISS AND RIDE DISEMBARKING AREA

WILLOW SPRINGS ES - OPTION # 1



Design Option 1 – 1st Level



Design Option 1 – 2nd Level



Design Option 2 – Site Plan

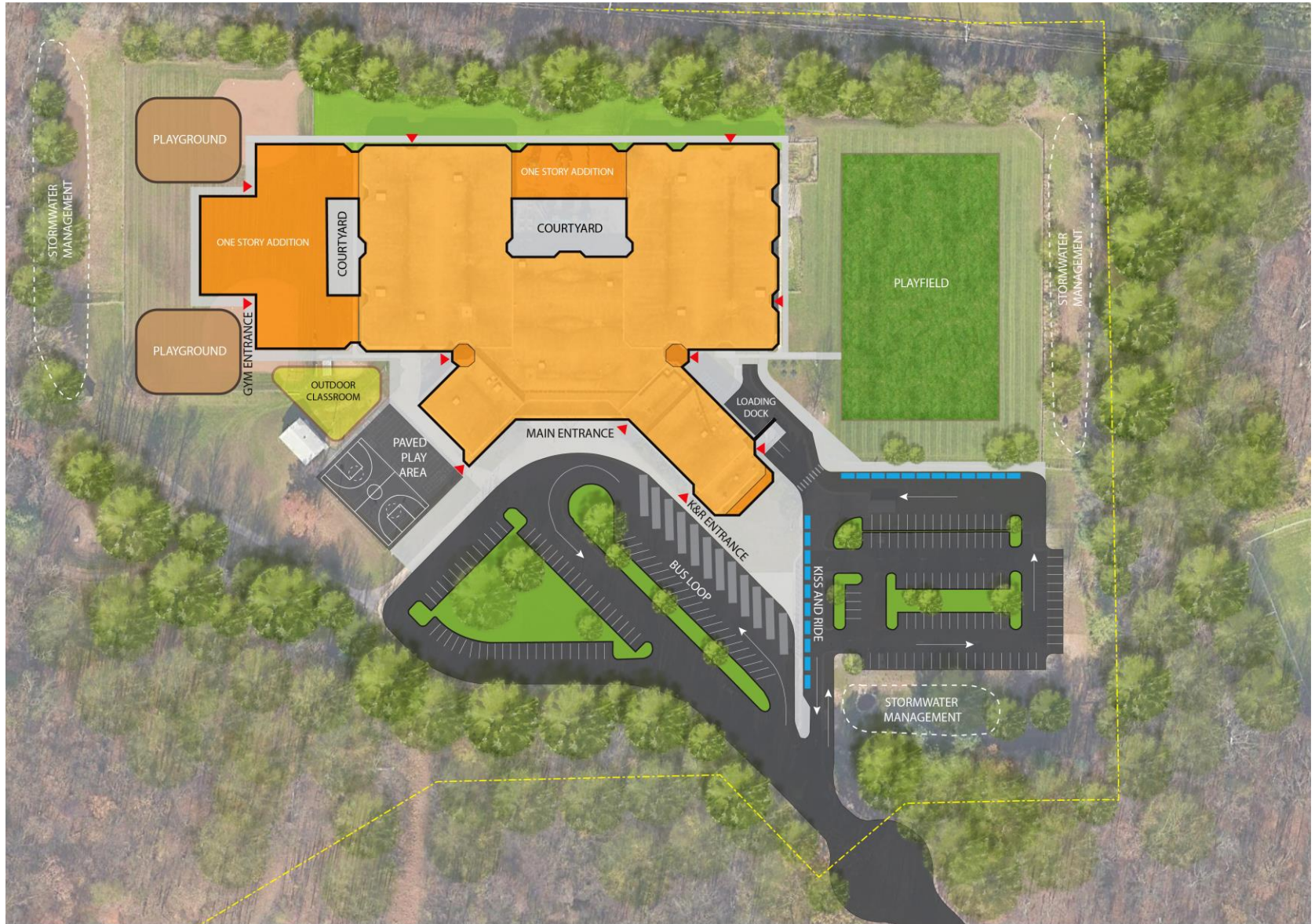

- EXISTING SCHOOL
- NEW ADDITION
- TO BE DEMOLISHED
- KISS AND RIDE DISEMBARKING AREA

WILLOW SPRINGS ES - OPTION # 2

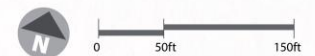

Design Option 2 – 1st Level



Design Option 3 – Site Plan

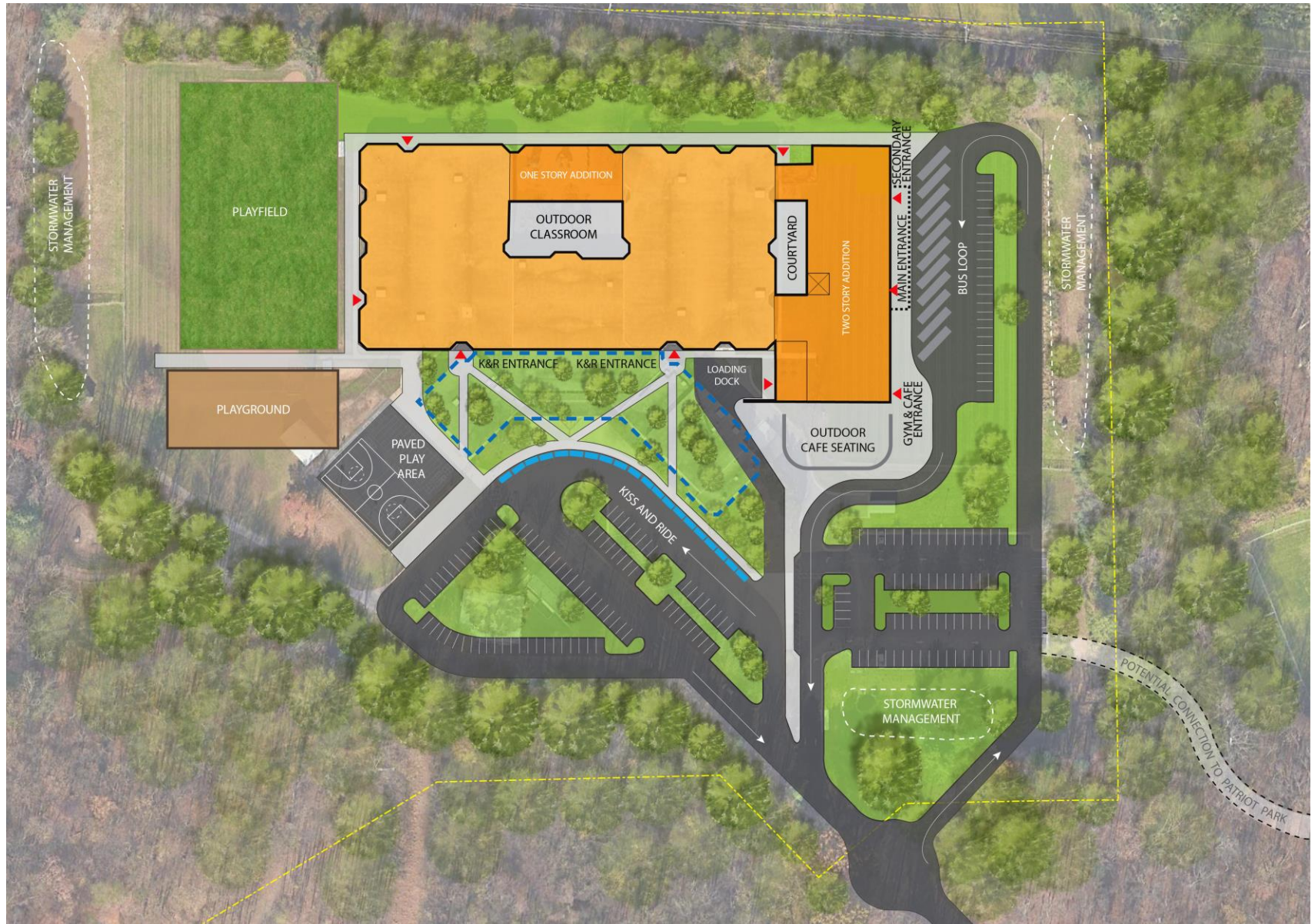

- EXISTING SCHOOL
- TO BE DEMOLISHED
- NEW ADDITION
- KISS AND RIDE DISEMBARKING AREA

WILLOW SPRINGS ES - OPTION # 3



Design Option 3 – 1st Level

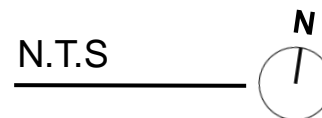

Design Option 3 – 2nd Level

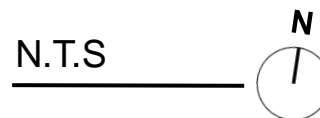
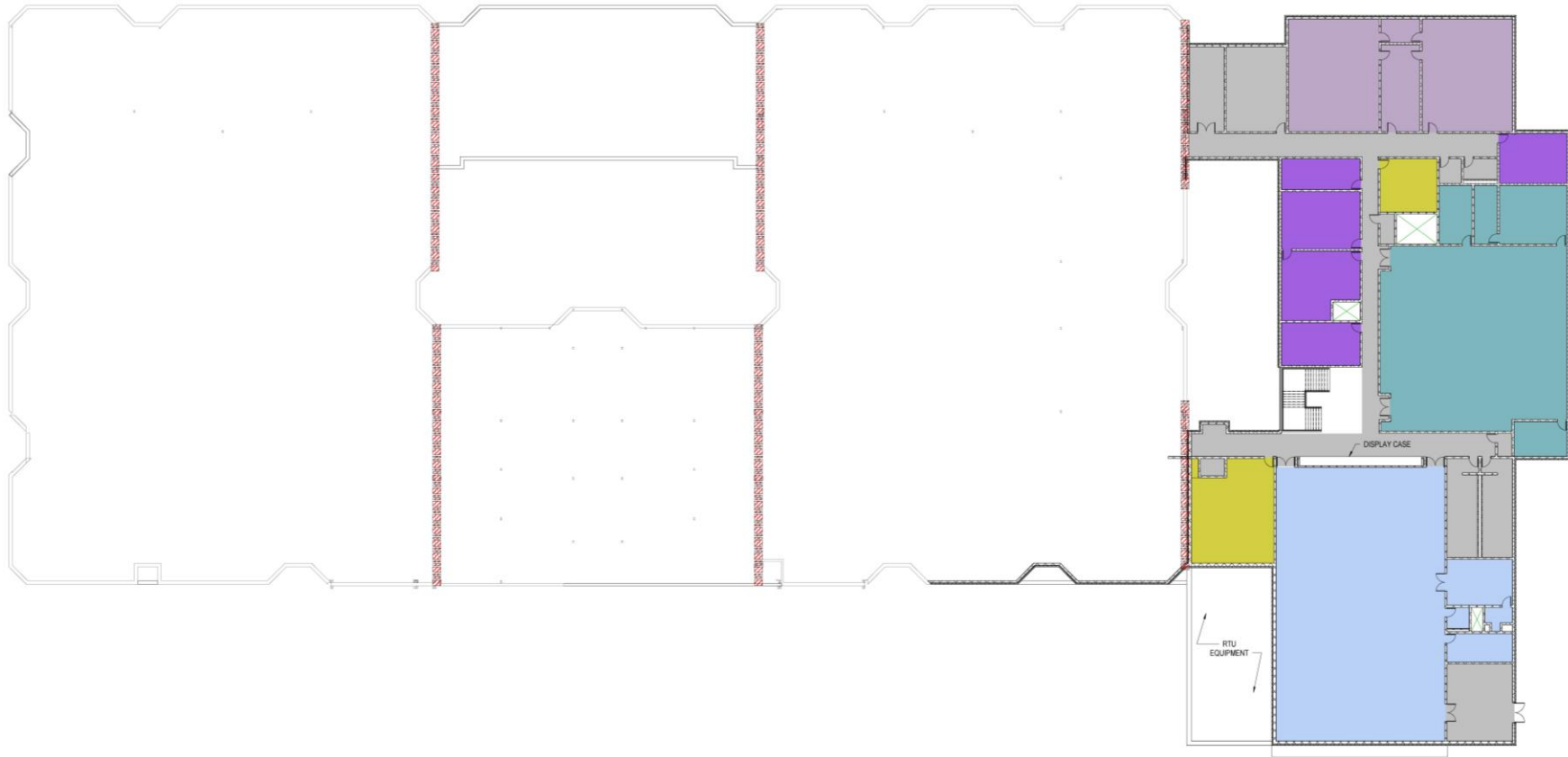

Thank you!

QUESTIONS?



Fairfax County
PUBLIC SCHOOLS
ENGAGE • INSPIRE • THRIVE

www.fcps.edu



SAMAHA