

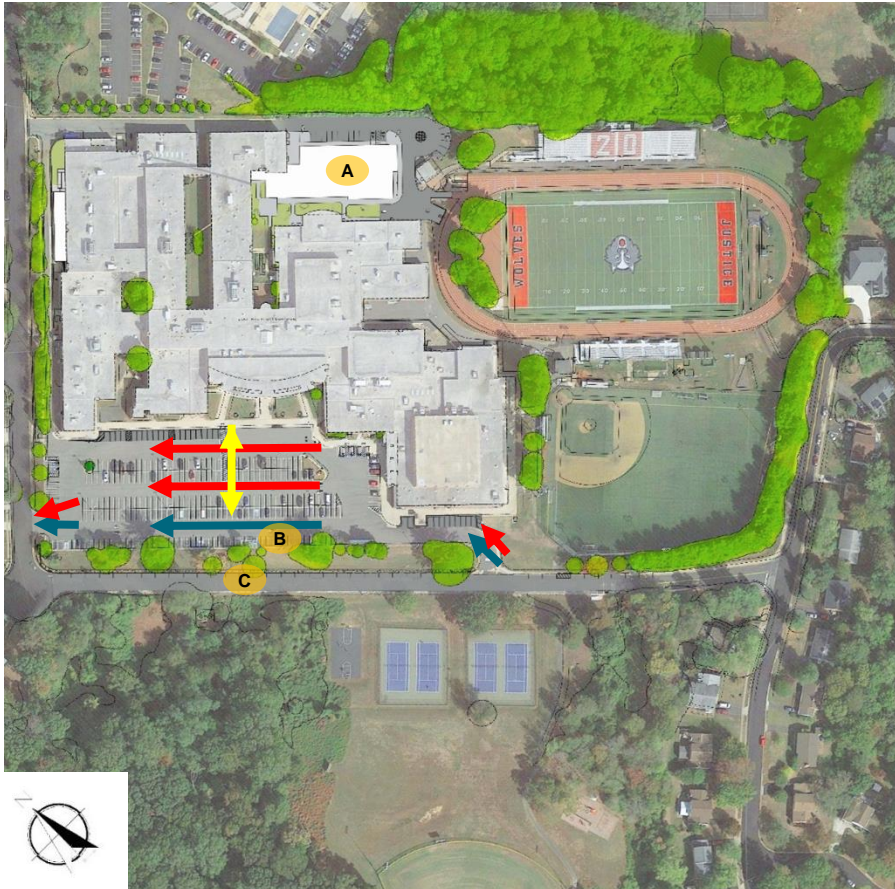

JUSTICE HIGH SCHOOL PARKING AND KISS & RIDE PLAN



PARKING

- A. CONSTRUCTION STAGING AND LAY-DOWN AREA
- B. SENIOR PARKING IN THE MAIN LOT ALONG TREE LINE
- C. OTHER STUDENT PERMIT PARKING ON PEACE VALLEY LANE

KISS & RIDE DROP-OFF/PICKUP

BUS LOOP TO CONTINUE ONTO THE SITE FROM PEACE VALLEY LANE
(FRONT OF SCHOOL)

- BUS 
- KISS & RIDE 
- CROSSWALK 

Green Features

- Collaboration for High Performance Schools (CHPS)
 - More efficient energy use, LED with lighting controls
 - Variable refrigerant flow (VRF) heating and cooling
 - Low E glazing
 - Continuous insulation in the walls and roof
 - Paints and wood products specified to emit low amount of VOC
 - Low flow toilets and sinks
- Solar for some domestic hot water
- Infrastructure for EV charging stations
- Roof reinforcement for future solar opportunity

SAFETY

- Student/staff safety is priority
- Mobile safety team that travels from site-to-site
- Inspect for compliance with OSHA, Fire Code, and general occupant safety.
- Reports generated and given to FCPS project team and contractor for compliance.
- Air quality checks when construction impacts occupied areas in the school to include temperature, carbon monoxide, dust, odors, etc.
- Most issues can be addressed within 24 hours.
- Work areas separate from instruction areas.
- Temporary partition walls
- Construction fencing
- Full time onsite FCPS construction representative

THANK YOU!

FOR MORE INFORMATION, GO TO www.fcps.edu and
SEARCH FOR JUSTICE HIGH SCHOOL CAPITAL PROJECT

OR

<https://www.fcps.edu/justice-high-capital-project>

