

BREN MAR PARK ELEMENTARY SCHOOL COMMUNITY MEETING #2



APRIL 12, 2023

Team Introduction

- FCPS Design and Construction Team
 - J.R. Van Meter – Coordinator

- Design Team
 - Perkins Eastman – Architect
 - Land Design – Civil Engineer
 - Ehlert Bryan – Structural Engineer
 - CMTA – MEP Engineer

Bren Mar Park Elementary School – Existing Satellite View



Project Budget

- \$4 million – Planning/Design – 2021 School Board (funded)

Project Timeline

- June 2, 2022 – Design Feedback Engagement Committee Meeting #1
- November 2, 2022 – Design Review Meeting with Design Feedback and Engagement Committee Meeting #2
- January 31, 2023 – 2232 Application Submitted to County
- March 14, 2023 – Community Meeting #1 (collect feedback)
- April 12, 2023 – Follow up with Community
- Spring 2023 – Final Construction Documents
- Spring/summer 2023 – Permit Submission
- Summer 2023 – District Land Use Committee
- TBD: Planning Commission
- Spring 2024 – Construction Bid and School Board meetings
- Spring 2024 – Summer 2026 – Construction Duration
- Fall 2026 – Renovation Complete

Project Scope

- FCPS 2021 Educational Specifications
 - Current Enrollment: 503
 - Current Program Capacity: 491
 - Proposed Design Capacity: 800
- Additions
 - Secondary Entrance
 - Cafeteria + Library
 - New Classrooms
 - Bus Loop
 - New Security Vestibule
 - Outdoor Classroom
- Renovations
 - Administrative Suite
 - Gymnasium renovation
 - Reconfigured and Renewed Classrooms and Support Spaces
 - Reconfigured Kiss & Ride Loop
 - Reconfigured Outdoor Play Areas
 - Occupied Phased Construction

School Design

Areas of sample rooms:

- Typical Kindergarten Classroom
 - Current: 843sf
 - Proposed: 1,005sf
- Typical 3rd Grade Classroom
 - Current: 800sf
 - Proposed: 825sf
- Gymnasium
 - Current: 5,376sf
 - Proposed: 5,376sf
- Cafeteria
 - Current: 2,421sf
 - Proposed: 4,000sf
- General Learning Areas:
 - Current: 33 Classrooms
 - Proposed: 42 Classrooms

Proposed Plan

- 2 story addition
- Improved floorplan (library, cafeteria, classrooms)
- Additional courtyards
- Site improvements
- Bus Loop and Kiss & Ride separated for efficiency

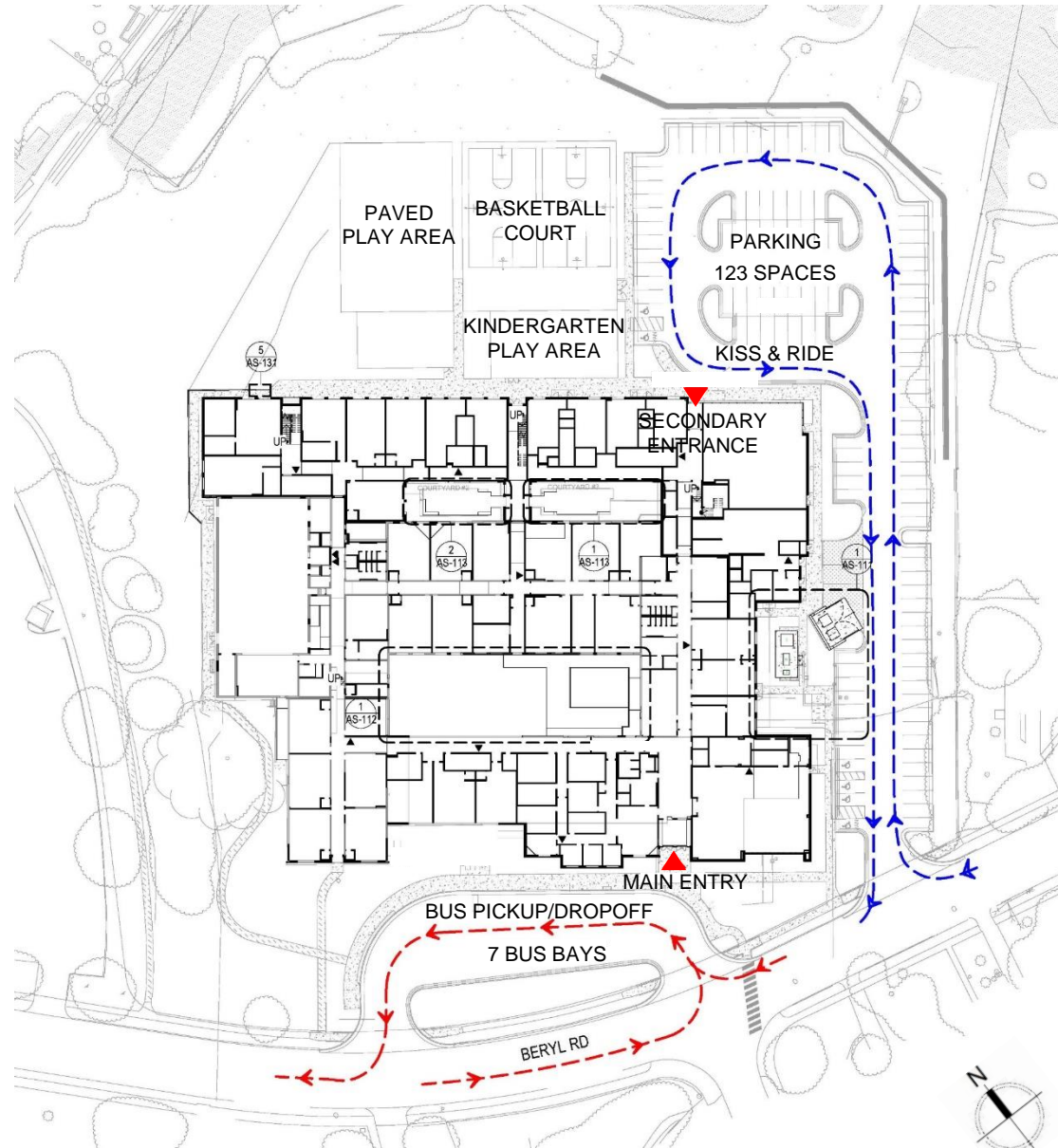

Proposed First Floor Plan



Proposed Second Floor Plan

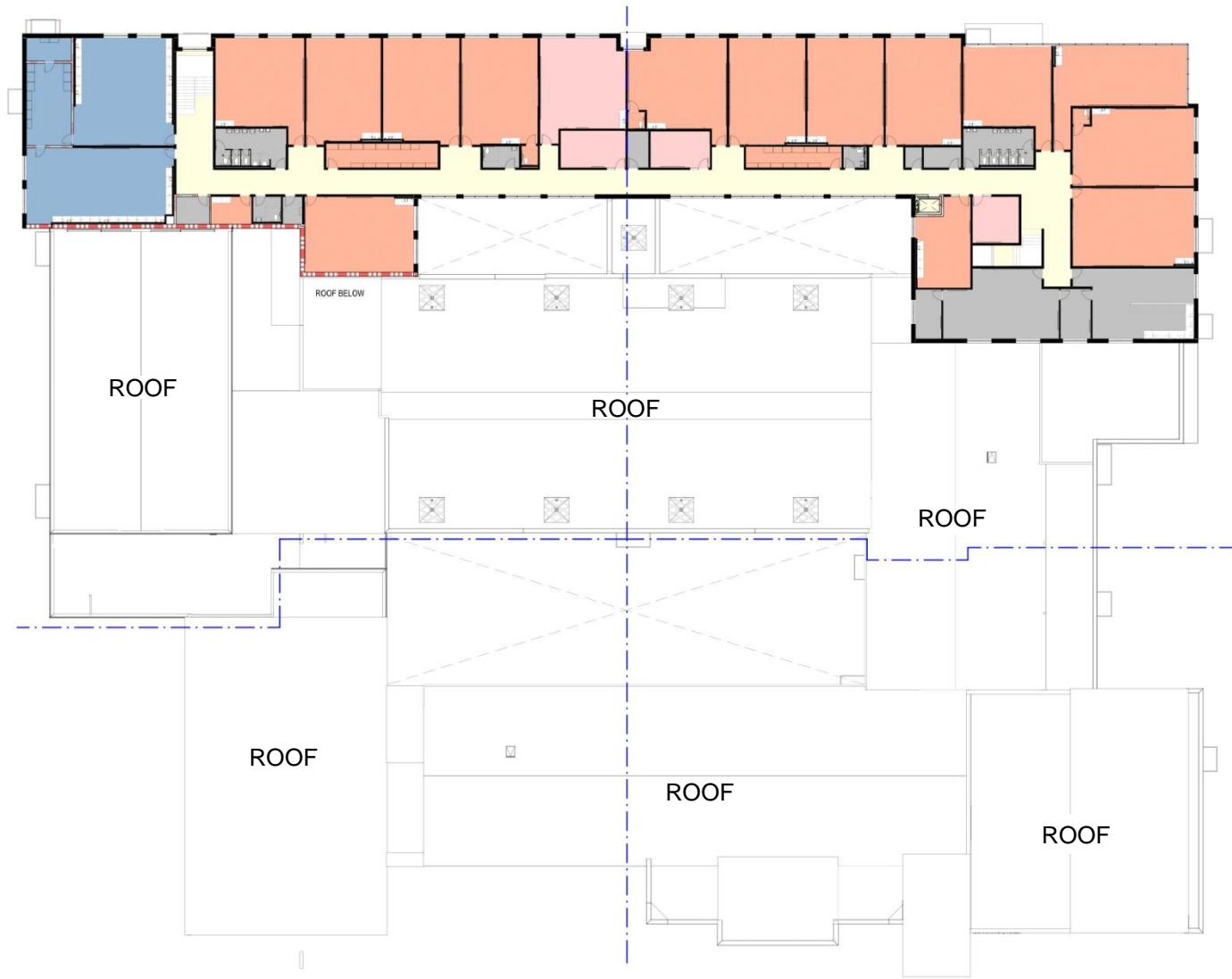

Exterior View



Proposed New Entry & Library

Exterior View



Proposed Cafeteria

School Design

- **Green Initiatives:** Project is designed to the Collaborative for High Performance Schools (CHPS) www.chps.net which helps our school become energy, water, and material efficient, well-lit, thermally comfortable, acoustically sound, safe, healthy and easy to operate.
- **Storm Water Management:** A new storm water management system is being designed and installed for this project. A new StormTech facility will be installed under the newly expanded parking lot.
- **Parking:**
 - Current – 73 spaces
 - Proposed – 123 spaces

Thank you!

FOR MORE INFORMATION, GO TO www.fcps.edu AND SEARCH FOR BREN MAR PARK ELEMENTARY

OR

<https://www.fcps.edu/bren-mar-park-elementary-capital-project>

