

# ARMSTRONG ELEMENTARY SCHOOL

## RESTON PLANNING & ZONING COMMITTEE



**OCTOBER 16, 2023**

# Project Timeline

- ❖ CIP – Planning and Design Funded
  - ❖ 2021 School Bond – Planning/Design
  - ❖ Unfunded – Construction
- ❖ Schematic Design Phase SPRING 2022
  - ❖ Design Feedback & Engagement Committee #1 SPRING 2022
- ❖ Design Development Phase SUMMER 2022
- ❖ Intermediate Design Phase FALL 2022
  - ❖ Design Feedback & Engagement Committee #2 FALL 2022
- ❖ Final Design Phase WINTER 2023
  - ❖ Community Meeting SPRING 2023
- ❖ Permitting 2023-2024
- ❖ Construction (2 years) Spring 2024
- ❖ Completion Summer 2026



# Existing Aerial View





# Existing Site Plan

PARKING SPACES: 110

BUSES: 11

SITE AREA: 14.309 AC

ZONING: PRC

EXISTING BUILDING  
AREA: 79,819 SF

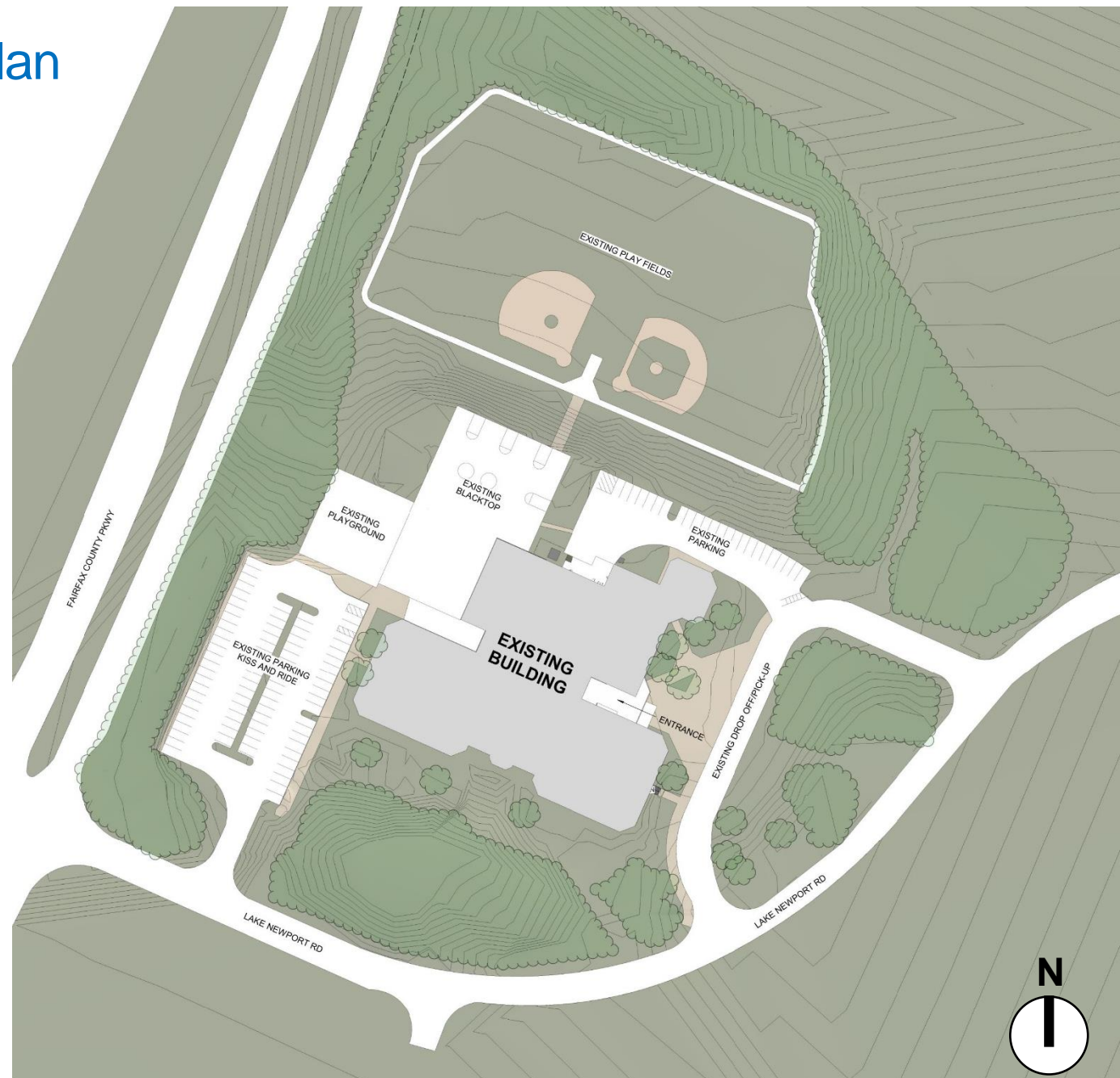

# Proposed Site Plan

PARKING SPACES: 146

BUSES: 14

SITE AREA: 14.309 AC

ZONING: PRC



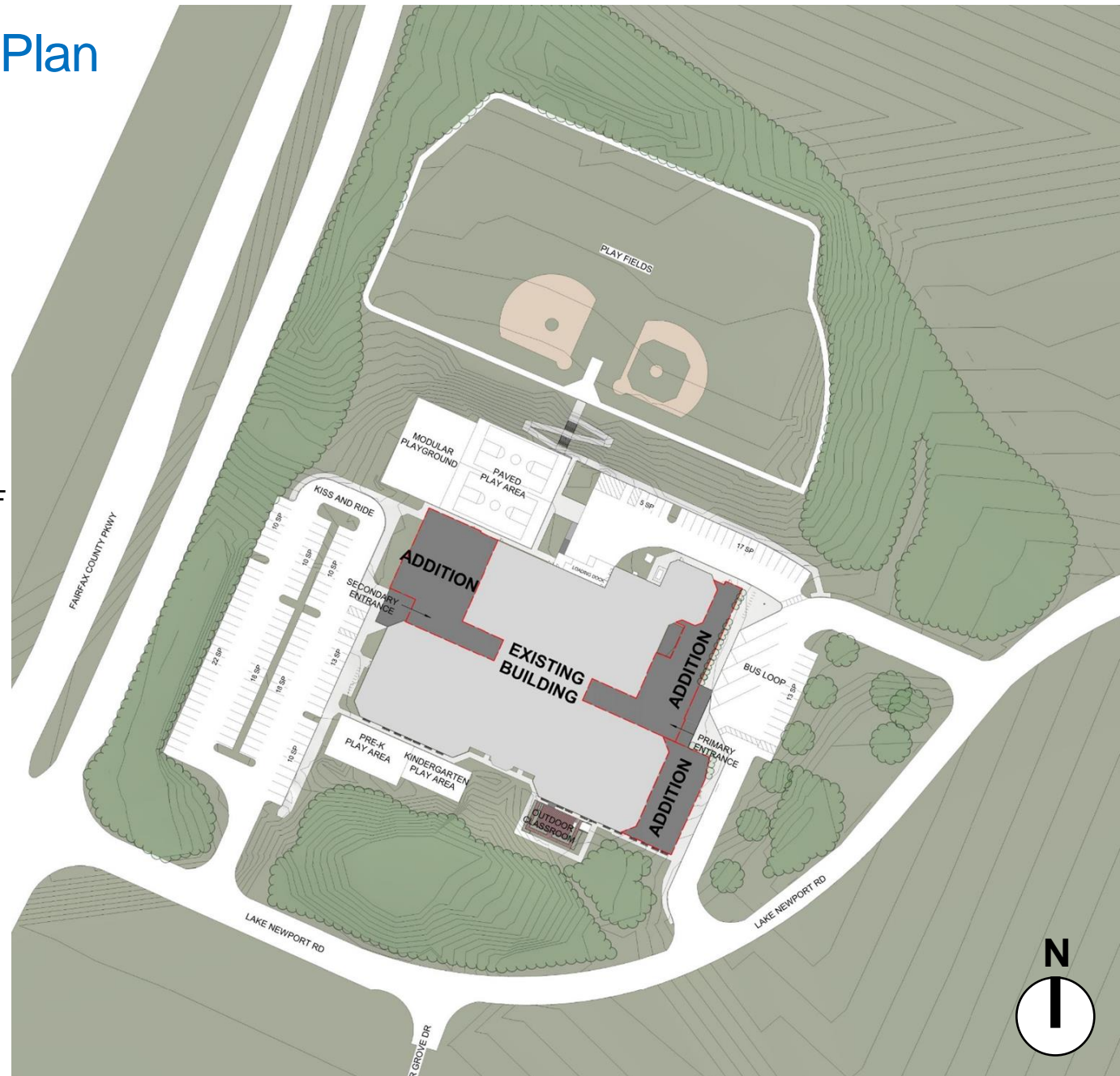

PROPOSED ADDITION  
AREA: 27,250 SF

PROPOSED OVERALL  
BUILDING AREA: 107,069 SF



# Existing Floor Plan First Floor



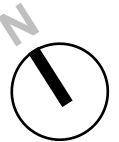
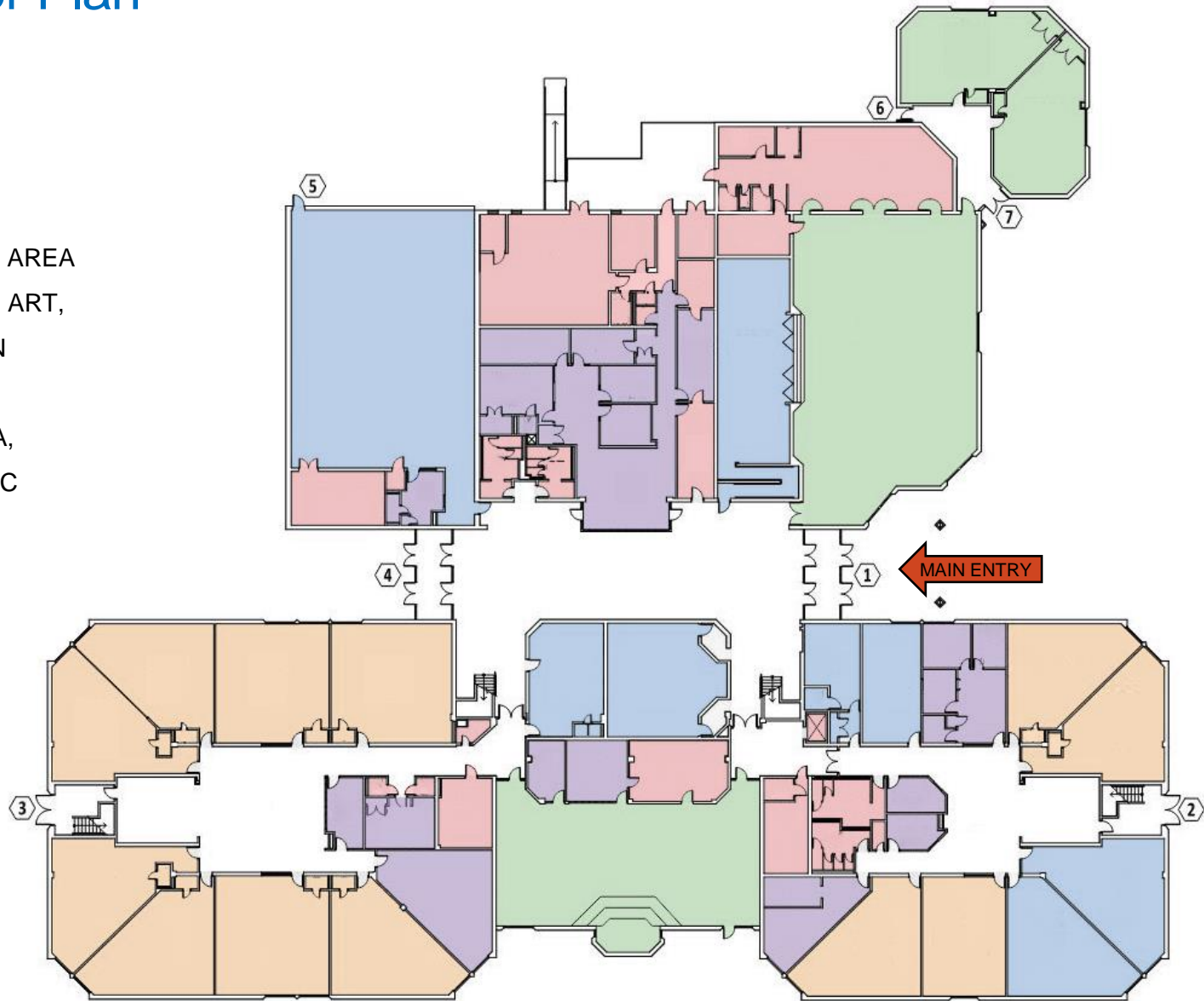

## LEGEND

-  GENERAL LEARNING AREA
-  GYMNASIUM, MUSIC, ART,  
SPECIAL EDUCATION
-  ADMIN & HEALTH
-  LIBRARY, CAFETERIA,  
FOOD SERVICE, SACC
-  OVERALL BUILDING  
SUPPORT



# Existing Floor Plan Second Floor

## LEGEND

-  GENERAL LEARNING AREA
-  GYMNASIUM, MUSIC, ART,  
SPECIAL EDUCATION
-  ADMIN & HEALTH
-  LIBRARY, CAFETERIA,  
FOOD SERVICE, SACC
-  OVERALL BUILDING  
SUPPORT

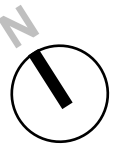
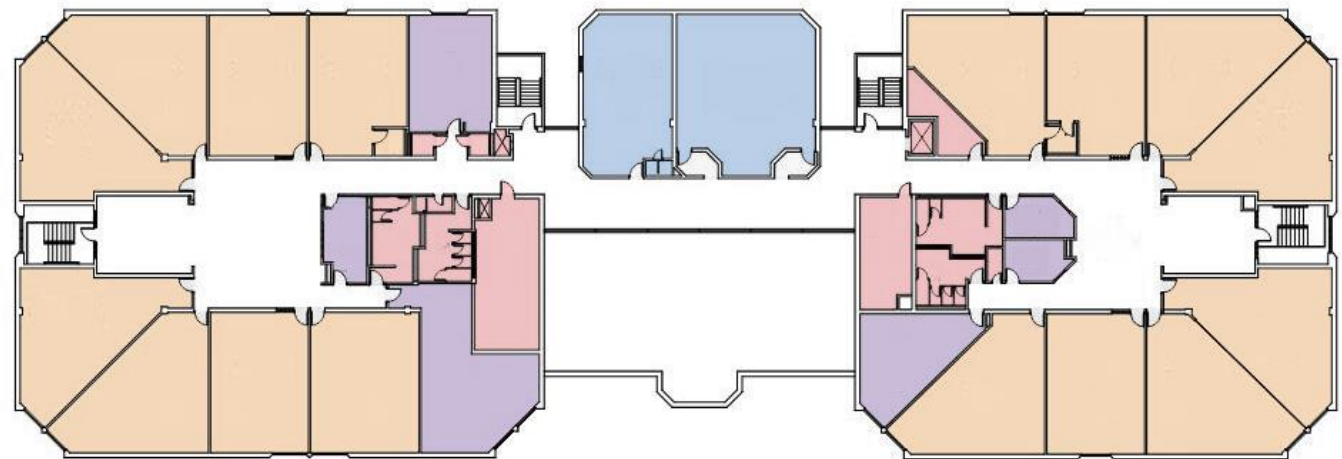







# Proposed Floor Plan

## First Floor

### LEGEND

-  GENERAL LEARNING AREA
-  GYMNASIUM, MUSIC, ART,  
SPECIAL EDUCATION
-  ADMIN & HEALTH
-  LIBRARY, CAFETERIA,  
FOOD SERVICE, SACC
-  OVERALL BUILDING  
SUPPORT

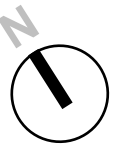







# Proposed Floor Plan

## Second Floor

### LEGEND

-  GENERAL LEARNING AREA
-  GYMNASIUM, MUSIC, ART,  
SPECIAL EDUCATION
-  ADMIN & HEALTH
-  LIBRARY, CAFETERIA,  
FOOD SERVICE, SACC
-  OVERALL BUILDING  
SUPPORT

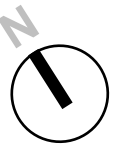
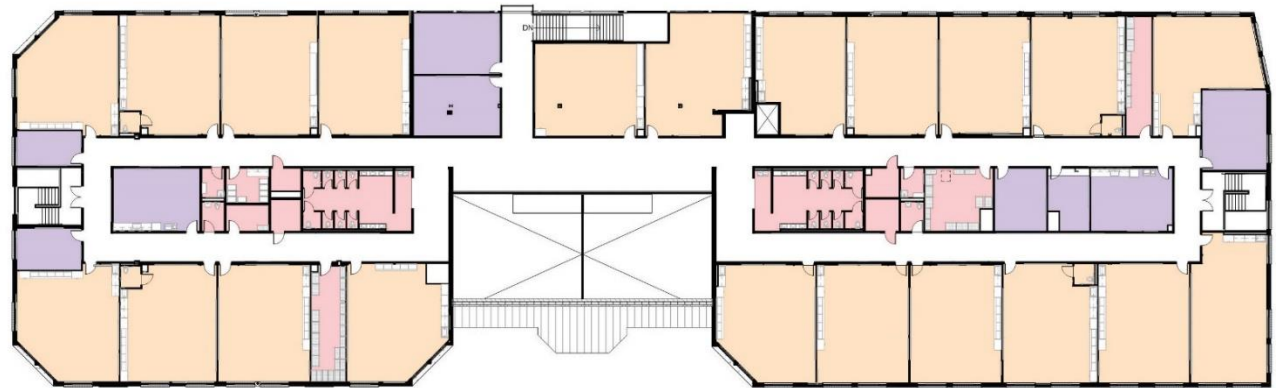

# Proposed Main Entry



Main Entry View - From Northeast



## Interior View



Main Street View - Looking Southeast

# Proposed New Library



Library View - From Northwest



## Interior View - New Library



Library View - Looking Northwest

# THANK YOU!

FOR MORE INFORMATION, GO TO [WWW.FCPS.EDU](http://WWW.FCPS.EDU) AND SEARCH FOR  
ARMSTRONG ELEMENTARY

OR

<https://www.fcps.edu/armstrong-elementary-capital-project>

